

Honeywell

Wireless Thermometer with Alarm Clock

(TE103NL)
USER MANUAL

TABLE OF CONTENTS

INTRODUCTION	3
ABOUT HIDEKI ELECTRONICS	3
PRODUCT OVERVIEW	4
REMOTE SENSOR	7
BEFORE YOU BEGIN	9
BATTERY INSTALLATION	10
LOW BATTERY WARNING	11
TABLE STAND	11
GETTING STARTED	11
CHECKING REMOTE AND INDOOR TEMPERATURES	12
MAXIMUM AND MINIMUM READINGS	12
LOST COMMUNICATION	13
CALENDAR AND CLOCK DISPLAY MODES	13
MANUAL SETTINGS	14
SNOOZE	15
DISABLING ALARM	15
PRECAUTIONS	16
SPECIFICATIONS	17
FCC STATEMENT	18
DECLARATION OF CONFORMITY	19
STANDARD WARRANTY INFORMATION	20

2

HONEYWELL TE103NL & TS03C MANUAL (ENG)
SIZE: W65 X H105 (mm)
BY WING TSUI 31/03/08

INTRODUCTION

Thank you for selecting the Wireless Thermometer with Alarm Clock. This device includes precise time keeping with temperature monitoring features that you can use from the comfort of your home.

In this package you will find:

- One main unit (receiver)
- One remote sensor (transmitter) TS03

Please keep this manual handy as you use your new item. It contains practical step-by-step instructions, as well as technical specifications and precautions you should know.

3

PRODUCT OVERVIEW

MAIN UNIT

FEATURES

- Wireless transmission of the temperature from the remote sensor to the main unit from up to 100 feet (30 meters) away
- Remote temperature display
- Indoor temperature display
- Quartz clock
- Calendar displaying date with month and day of the week in English, Spanish, French, German or Italian
- Dual crescendo alarm with snooze feature
- Programmable Freeze Pre-Alarm
- Wall mount or desktop option
- Low battery indicator

4

FRONT VIEW
WEATHER AND PRECISE TIME INFORMATION
IN A THREE - LINE LCD DISPLAY

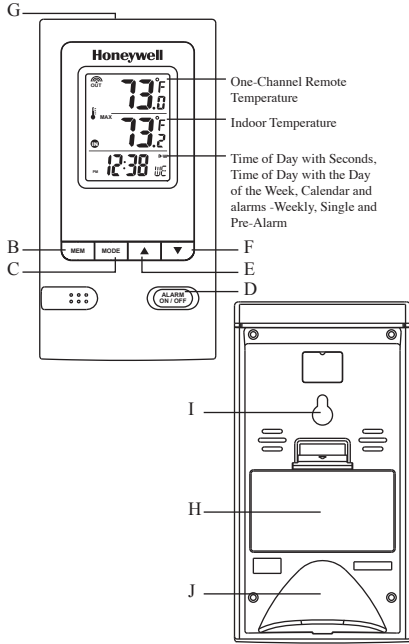

5

B. MEMORY BUTTON

- Press to toggle between current temperature, minimum and maximum. Readings include both the indoor and outdoor temperatures
- Press & hold to clear memory

C. MODE BUTTON

- Toggles between the (5) clock modes
 - Month & Date,
 - Time with seconds,
 - Time with the day of the week,
 - Time with Zone and seconds,
 - Time with Zone and day of week

D. ALARM BUTTON

- Switches between 3 alarm modes
- weekly, single alarm and pre-alarm modes

E. UP (▲) BUTTON

- Increments all function parameters
- Enables any of the alarms

F. DOWN (▼) BUTTON

- Decrements all function parameters
- Disables all available alarms
- Enforces the remote sensor signal search

G. SNOOZE BUTTON

- Stops any alarm temporarily

H. BATTERY COMPARTMENT

- Accommodates 2 (two) UM-3 or AA 1.5V alkaline batteries.

I. WALL-MOUNT RECESSED HOLE

- Used to mount the main unit on the wall

J. REMOVABLE TABLE STAND

- Keeps unit in upright position on a flat surface

6

REMOTE SENSOR
FEATURES

- Remote temperature transmission to the main unit via 433 MHz signal
- Case can be wall mounted using built-in hanger
- 100 feet (30 meters) transmission range without interference
- Selection of the temperature display in Celsius or Fahrenheit
- Channel selection

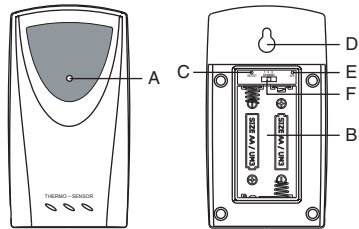

A. LED INDICATOR

- Flashes once: in 40-60 second intervals when the remote sensor transmits a reading to the main unit.
- Flashes twice: when battery power is low.

B. BATTERY COMPARTMENT

- Holds two AA-size batteries

C. RESET

- Resets all readings

D. WALL-MOUNT RECESSED HOLE

- Mounts the remote sensor on the wall

E. °C/°F SWITCH

- Selects the temperature display in Celsius or Fahrenheit

F. CHANNEL SWITCH

- Selects the desired channel

7

8

BEFORE YOU BEGIN

- The remote sensor can be placed indoors or outdoors, the main unit must be placed indoors.
- We recommend using alkaline batteries for the remote sensor and main unit when temperatures are above 32°F (0°C). We recommend using AA lithium batteries for the remote sensor when temperatures are below 32°F (0°C).
- Avoid using rechargeable batteries. (Rechargeable batteries cannot maintain correct power requirements).
- Insert batteries before first use, matching the polarity in the battery compartment.
- **ALWAYS** install batteries in the remote sensor *before* the main unit.
- Press **RESET** after each battery change with a paper clip or similar tool.
- During an initial setup, place the main unit as close as possible to the remote sensor.
- After reception is established (the remote temperature will appear on the main unit's display), position the remote sensor and the main unit within the effective transmission range of 100 feet (30 meters).

NOTE:

1. Avoid setting manually the time and date on the main unit *before the remote temperature is displayed.*
2. The effective operating range may be influenced by the surrounding building materials and how the receiver and transmitter are positioned.
3. Place the remote sensor so that it faces the main unit (receiver), minimizing obstructions such as doors, walls, and furniture.
4. Though the remote sensors are weather-resistant, they should be placed away from direct sunlight, rain or snow.

9

NOTE: Batteries in the outdoor remote sensors may have reduced voltage supply and a shorter effective range at temperatures below freezing. We recommend using lithium batteries below 32°F (0°C).

BATTERY INSTALLATION REMOTE SENSOR

NOTE: Install the batteries; select the channel and temperature in C° or F° before mounting the remote sensor.

- Remove the screws from the battery compartment with a small Phillips screwdriver.
- Select the desired channel. The switch is located in the battery compartment. Channel 1 is the default setting and typically selected if only one remote sensor is being used.
- Install 2 "AA" size alkaline batteries (not included) matching the polarities shown in the battery compartment.
- Replace the battery compartment door and secure the screws.
- Secure remote sensor in the desired location.

MAIN UNIT

- Open the battery compartment door.
- Install 2 batteries (UM-3 or "AA" size 1.5V) matching the polarity as shown in the battery compartment.
- Replace the battery compartment door.

10

LOW BATTERY WARNING

A low-battery indicator [🔋] will appear on the indoor or remote temperature reading line of the main unit warning that the corresponding batteries need replacement.

TABLE STAND

The main unit has a removable table stand that supports it on the flat surface. Attach table stand to the bottom of the main unit in the slots provided. The unit can also be mounted on the wall using the recessed screw hole. The table stand must be removed prior to mounting.

GETTING STARTED

After batteries are installed; the remote sensor will transmit temperature readings at 45 second intervals. The main unit may take up to two minutes to receive the initial readings. Upon successful reception, remote temperature will appear on the top line of the main unit's display. The main unit will automatically update readings at 45-second intervals.

If no signals received from the remote sensor within two minutes, dashes [- - -] will be displayed. Press and hold **DOWN** (▼) button on the main unit for two seconds to initiate another signal search.



11

CHECKING REMOTE AND INDOOR TEMPERATURES

The remote temperature information line is located on the top of the main unit's display.

The wave icon is located above the remote channel number and indicates the reception status from the remote sensor.

There are three remote status types:

The unit is in searching mode.	
Temperature readings securely registered.	
No signals detected.	- - -

The indoor temperature with the icon **IN** is located below the remote temperature information line.

NOTE: If the indoor or remote temperature goes above or below operating range stated in specifications, the main unit's display will show dashes "- - -"

MAXIMUM AND MINIMUM READINGS

The maximum and minimum record of the indoor and remote temperatures will be automatically stored in the memory of the main unit (receiver).

To display the minimum, maximum or the current reading press **MEMory** button.

If no button is pressed for the next 15 seconds, the unit will return to the current temperature display.

To clear the memory, press and hold **MEMory** button for two seconds and all previously stored readings will be erased.

12

LOST COMMUNICATION

If the main unit display line for the remote sensor reading goes blank, press and hold **DOWN** (▼) button for 2 seconds to begin a new signal search. If the signal still isn't received, make sure that remote sensor is in its proper location:

- The distance between main unit and remote sensor is not over 100 feet (30meters).
- The path between units is clear of obstacles. Reduce the distance as necessary.
- Fresh batteries are installed correctly in both units.

If there is no reception, please perform the following steps:

- Bring the main unit and remote sensor close together.
- Remove four (4) small screws from the back of the remote sensor with small Phillips screwdriver, and open the battery compartment.
- Remove the batteries from the battery compartment and reinstall them in the same manner. Remote sensor LED indicator will flash showing transmission of the signal.
- Remove the batteries from the main unit and reinstall them in the same manner.
- The remote temperature appeared on the main unit's display will show that transmission is being received successfully.

CALENDAR AND CLOCK DISPLAY MODES

Date is displayed in month-date or date-month format. Each press of the **MODE** button will change the clock display setting between the time of day with seconds, time of day with the day of the week and a calendar.

13

MANUAL SETTINGS

CLOCK

- Press and hold **MODE** button for 3 seconds: the year digits will flash.
- Press **UP** (▼) or **DOWN** (▲) to change flashing digits.
- After the first value is set, press **MODE** button again to confirm.
- Continue setting month, date, time display format, 12 or 24 hour time format, hour, minute, day of the week display language, time zone and Fahrenheit or Celsius display.
- Press **MODE** for the last time to return to the default mode (time of day with seconds) after the last parameter is set.

ALARMS

(W) Weekly Alarm

The alarm will sound and the alarm icon will flash at the set time Mondays through Fridays.

(S) Single Day Alarm

The alarm will sound and the alarm icon will flash at the set time, but will not activate on subsequent days.

(PRE-AL) Low Temperature Pre-Alarm for remote location

If the remote temperature reaches 32°F (0°C) or below, the pre-alarm feature will be activated. The pre-alarm time interval can be set for 15, 30, 45, 60 or 90 minutes earlier than the day of the week or single alarm time. Press and hold **ALARM** button for two seconds in Pre-Alarm mode to set the pre-alarm interval.

W (Weekly alarm), **S** (Single day alarm), and **PRE-AL** (Pre-alarm) icons will indicate which alarm mode is armed. You can enable or disable an alarm by pressing the **UP** (▼) or **DOWN** (▲) buttons in the selected alarm display mode. Press **ALARM** button to toggle between alarm modes or to return to the default display.

14

SETTING THE ALARM

To set any alarm,

- Press **ALARM** button once to display alarm time. If the alarm is off, **OFF** will be displayed.
- Press and hold **ALARM** button for two seconds. The hour digit will flash.
- Enter the hour using **DOWN** (▼) or **UP** (▲).
- Press **ALARM** button again. The minute digits will flash.
- Enter the minutes using **DOWN** (▼) or **UP** (▲).
- Press **ALARM** button again to exit.
- Repeat the same procedure to set a Single and Pre-Alarm.

SNOOZE

When the alarm sounds, press the **SNOOZE** button to temporarily stop the alarm. After the **SNOOZE** is depressed, the alarm sound will resume in five (5) minutes. If the alarm is not disabled after that, it will sound for four (4) more minutes and then will stop by itself.

DISABLING ALARM

Press **ALARM** button on the main unit to disable any of the alarms. When Weekly, Daily or Pre-Alarm is disabled, an applicable icon **W**, **S**, or **Pre-AL** will disappear from the main unit's display.

15

PRECAUTIONS

This product is engineered to give you years of satisfactory service if handled carefully. Here are a few precautions:

- Do not immerse the units in water.
- Do not clean the units with abrasive or corrosive materials. They may scratch the plastic parts and corrode the electronic circuits.
- Do not subject the product to excessive force, shock, dust, temperature, or humidity, which may result in malfunctions, shorter lifespan, damaged batteries, and damaged parts.
- Do not tamper with the units internal components. Doing so will invalidate the warranty and may cause damage. These units contain no user-serviceable parts.
- Use only fresh batteries. Do not mix new and old batteries.
- Read the user's manual thoroughly before operating the units.

TRANSMISSION COLLISION

Signals from the other household devices such as wireless doorbells, home security systems, and entry control, may interfere with this product or cause temporary reception interruption. This is normal and will not affect the general performance of the product. The transmission and reception of the temperature readings will resume once the interference subsides.

16

SPECIFICATIONS

Main Unit

Indoor Temperature

Proposed operating range: -5.0°C to +50.0°C/23.0°F to 122.0°F

Temperature resolution: 0.1°C/0.2°F

User-selectable (°F or °C) temperature display

Low battery indicator

Calendar and Clock

12/24 hour display in hh: mm format

Date format: month-day or day-month format

Day of the week: User-selectable in five languages (English, Spanish, French, German, Italian)

Time Zone manual adjustment

Dual two-minute crescendo alarms with a four minutes snooze

Freeze pre-alarm with programmable time intervals

Wall Mount or Desktop option

Remote Sensor

Remote Temperature

Proposed operating range with alkaline batteries:

-20.0°C to + 70.0°C/-4.0°F to + 158°F

Proposed operating range with lithium batteries:

-38.8°C to + 70.0°C/-38.0°F to +158°F

Temperature resolution: 0.1°C/0.2°F

Low battery indicator

RF Transmission Frequency: 433 MHz

Maximum number of remote sensors: 1 (included)

RF transmission range: Maximum 100 feet (30 meters)

Temperature transmission cycle: approximately 45 seconds

Power

Main unit: 2 AA size (UM-3) 1.5V batteries (not included)

Remote Sensor: 2 AA size (UM-3) 1.5V batteries (not included)

Dimensions

Main unit: 2.64(L) x 4.84(H) x 1.02(D) inches

Remote sensor: 2.37(L) x 4(H) x 1(D) inch

FCC STATEMENT

This device complies with Part 15 of the FCC Rules.

Operation is subject to the following two conditions:

- (1) This device may not cause harmful interference, and
- (2) This device must accept any interference received, including interference that may cause undesired operation.

Warning: Changes or modification to this unit not expressly approved by the party responsible for compliance could void the user’s authority to operate the equipment.

NOTE: This equipment had been tested and found to comply with the limits for a Class B Digital device, pursuant to Part 15 of the FCC Rules. These limits are designed to provide reasonable protection against harmful interference in a residential installation. This equipment, installed and used in accordance with the instructions, may cause harmful interference to radio communications.

There is no guarantee that interference will not occur in a particular installation. If this equipment does cause harmful interference to radio or television reception, which can be determined by turning the equipment off and on, the user is encouraged to improve or correct turning the interference by one or more of the following measures:

- Reorient or relocate the receiving antenna
- Increase the separation between the equipment and receiver.
- Connect the equipment to an outlet on a circuit different from that to which the receiver is connected.
- Consult the dealer or an experienced radio / TV technician for help.

DECLARATION OF CONFORMITY

We

Name: Hideki Electronics, Inc.

Address: 7865 SW Mohawk, Tualatin, OR 97062

Telephone No.: 1-503-612-8395

declare that the product

Product No.: TE103NL

Product Name: Wireless Thermometer with Alarm Clock

Manufacturer: Hideki Electronics Ltd.

Address: Unit 2304-06, 23/F Riley House, 88 Lei Muk Road, Kwai Chung, New Territories, Hong Kong is in conformity with Part 15 of the FCC Rules.

Operation is subject to the following two conditions:

This device may not cause harmful interference. This device must accept any interference received, including interference that may cause undesired operation.

The information above is not to be used as a contact for support or sales. Please call our customer service hotline (refer to the Standard Warranty Information) for all injuries instead.

STANDARD WARRANTY INFORMATION

This product is warranted from manufacturing defects for one year from date of retail purchase. It does not cover damages or wear resulting from accident, misuse, abuse, commercial use, or unauthorized adjustment and repair.

Note that online product registration is required to ensure valid warranty protection.

To register your product, go to our Company website at: www.digiviewtime.com. Click Online Product Registration under the Customer Service menu. Contact our Customer Service Hotline 1(866) 443-3543 for assistance with this product and its operation.

Please direct all returns to the place of the original purchase. Should this not be possible, contact Hideki Customer Service Hotline for assistance and to obtain a Return Merchandise Authorization (RMA). Returns without a return authorization will be refused. Retain your original receipt as you may be asked to provide a copy for proof of purchase.

Hideki Electronics, Inc. reserves the right to repair or replace the product at our option.

©2008 Hideki Electronics, Inc. All rights reserved. Weathertime is a trademark of Hideki Electronics, Inc. The Honeywell trademark is used under license from Honeywell International Inc. Honeywell International Inc. makes no representations or warranties with respect to this product.